



Tonnelier Road, Dunkirk
£1,000 pcm





47Tonnelier Road

Dunkirk, Nottingham

Comfort Estates are pleased to present this well-presented furnished flat, located on a quiet street close to the Queen's Medical Centre and offering excellent access to Nottingham City Centre.

In brief, the property comprises an entrance hallway, one double bedroom, a further smaller bedroom ideal as a home office or guest room, a bathroom, and an open plan living and dining area with access to a private balcony. The kitchen comes complete with appliances included.

The flat also benefits from one allocated parking space.

Excellent transport links are nearby, with both tram and bus stops just a few minutes' walk away. The property is also within walking distance of Highfields Park and the University of Nottingham campus.

Available from 13th July 2026 - get in touch today to arrange a viewing.





Kitchen - 9' 5" x 8' 0" (2.88m x 2.44m)

Leading off the dining area is the well proportioned kitchen overlooking the back of the building. There is a range of beech wall and base units with a tiled splashback. The appliances included are; electric oven and hob, extractor fan, fridge/freezer and washing machine.

Lounge/Diner - 20' 4" x 9' 5" (6.20m x 2.88m)

A welcoming and spacious room with a designated living and dining area including a sofa, coffee table and dining table with chairs. The room is neutrally decorated, having white walls and laminate flooring throughout. There is a door leading to a balcony providing a lovely outdoor area. The space also provides access to a small balcony.

Hallway

Neutrally decorated and providing space to store shoes and coats

Bedroom 1 - 11' 2" x 8' 11" (3.40m x 2.71m)

A good sized double bedroom, neutrally decorated with white walls and laminate flooring including a bed, mattress, chest of drawers, bedside tables and large wardrobes.

Bedroom 2 - 8' 10" x 6' 7" (2.70m x 2.00m)

A good sized single room or the perfect home office. This room is neutrally decorated with laminate flooring and white walls, it includes built in shelving and cabinets.

Bathroom - 6' 10" x 5' 11" (2.08m x 1.80m)

With WC, vanity washbasin with mirror over and corner shower cubicle.





Comfort Estates

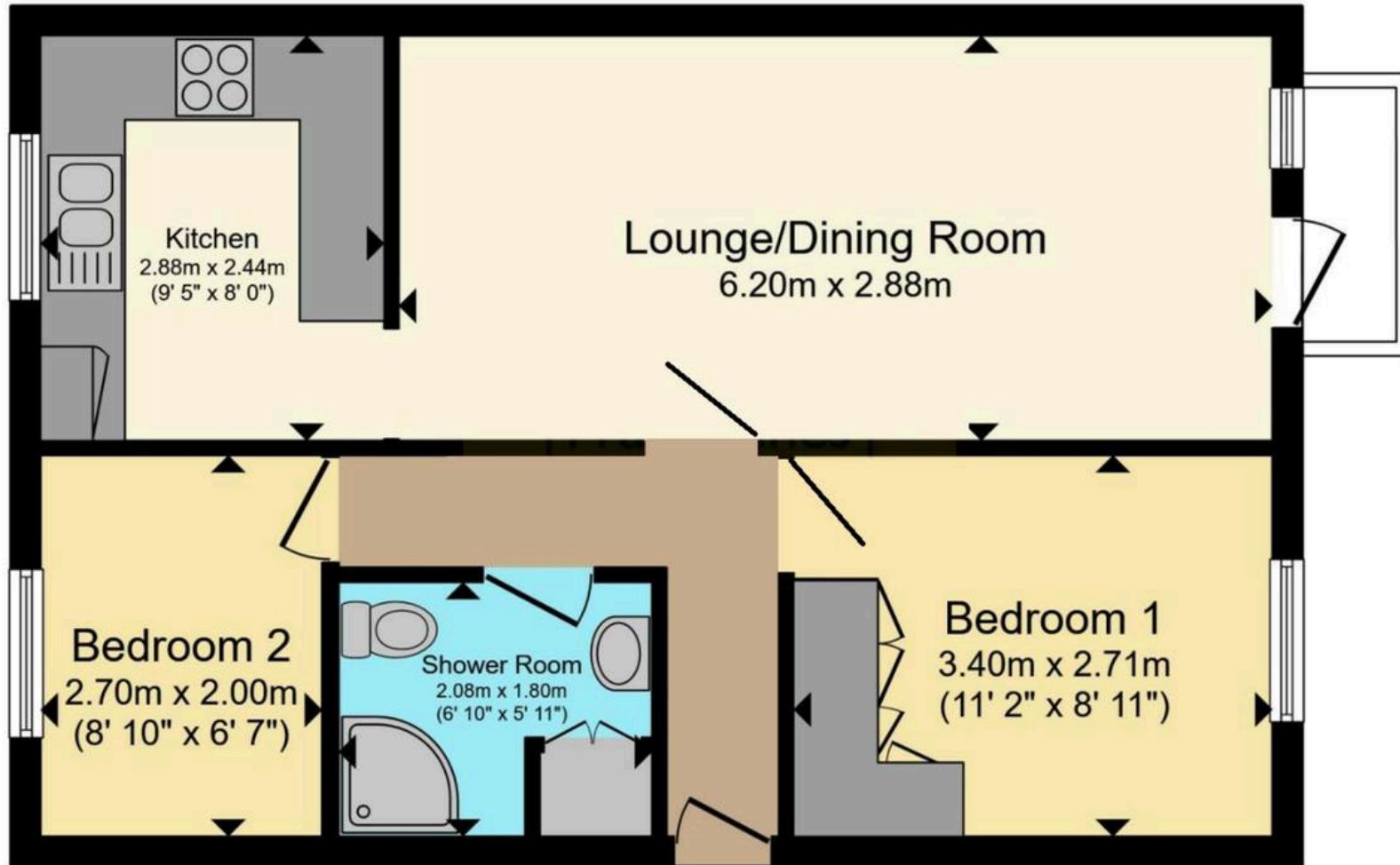



Comfort Estates

Comfort Estates, 47 Derby Road - NG1 5AW

0115 933 8997 • info@comfortestates.co.uk • www.comfortestates.co.uk