



Fondant Court, Bow, E3

Guide Price £350,000



## Fondant Court, Bow, E3

London

Price Guide £350,000 - £375,000 Nestled in the vibrant heart of East London, this exquisite purpose-built flat offers a perfect blend of modern living and urban convenience. Spanning an impressive 689 square feet, this property boasts two well-appointed bedrooms, making it an ideal choice for professionals, couples, or small families seeking a stylish city abode.

- Dual Aspect Canary Wharf And City Views
- Private Balcony
- Two Bedroom Apartment
- Lift Access To All Levels
- Positioned On The 11th Floor
- Open Plan Living Area
- Modern Gated Development
- 24 Hour Concierge



Situated on the 11th floor, the flat benefits from an abundance of natural light, courtesy of its bright, floor-to-ceiling windows that face south. This feature not only enhances the spacious feel of the living area but also provides stunning views of the cityscape, creating a serene atmosphere to unwind after a busy day.

Positioned off the spacious bright reception room, the property boasts a private balcony, perfect for enjoying a morning coffee or an evening glass of wine while taking in the sights and sounds of London. Residents will also appreciate the convenience of a 24-hour concierge service, ensuring peace of mind and assistance whenever needed.

The apartment combines contemporary design with practical amenities, making it a desirable option for those looking to embrace the dynamic lifestyle that London has to offer. In the prime location of Bow offering modern features and exceptional views, this property is not to be missed.

Council Tax band: D

Tenure: Leasehold

EPC Energy Efficiency Rating: B

EPC Environmental Impact Rating: B



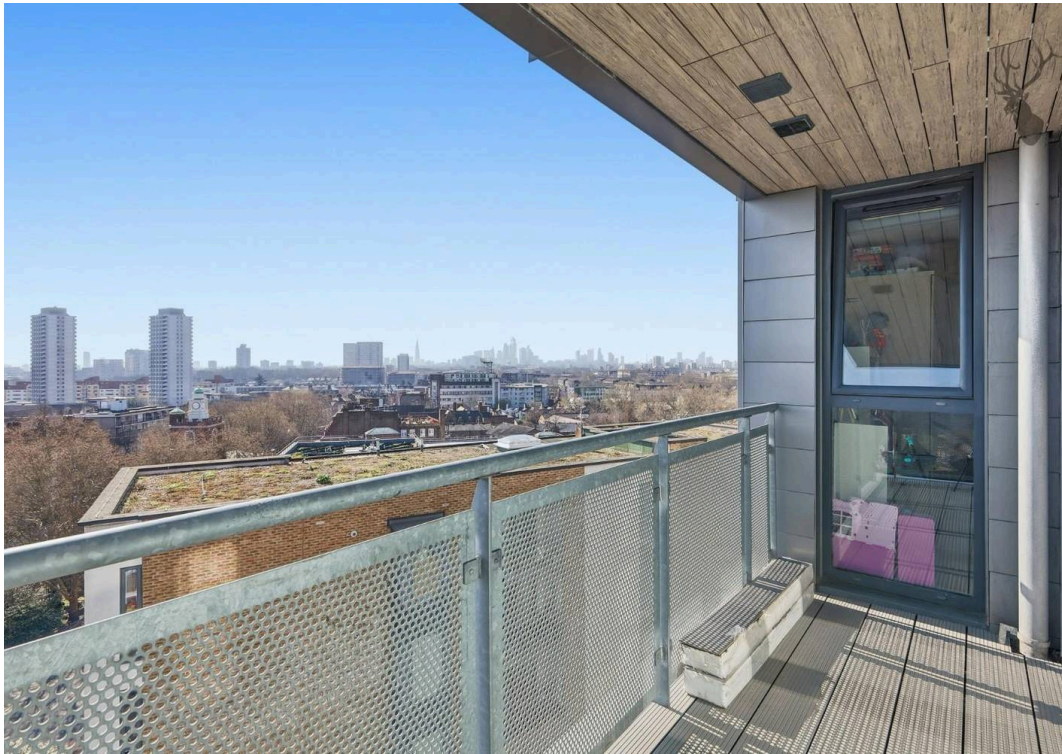

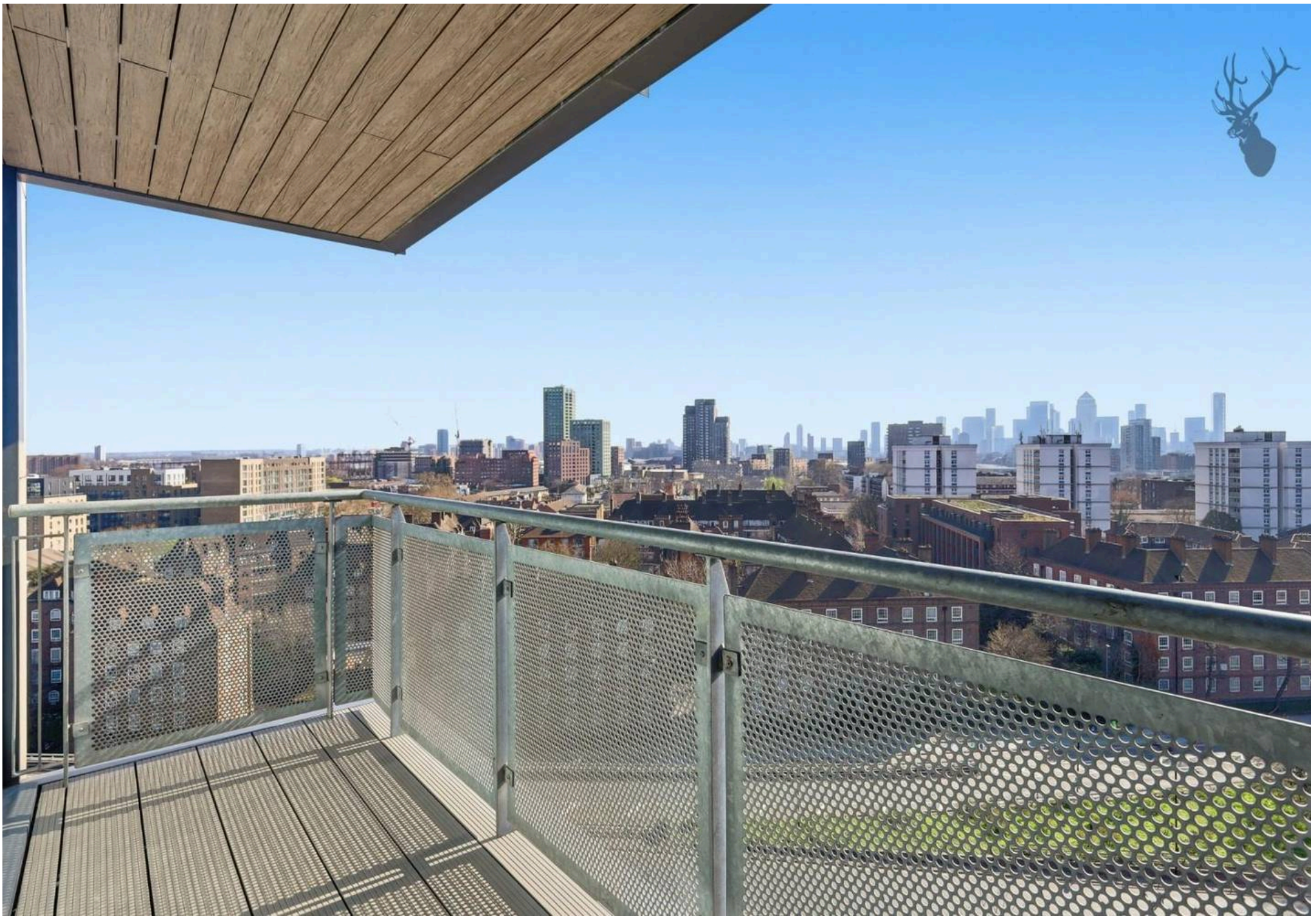

# Taylor Place

Approx. Gross Internal Area 64 sq. metres (688.9 sq. feet)

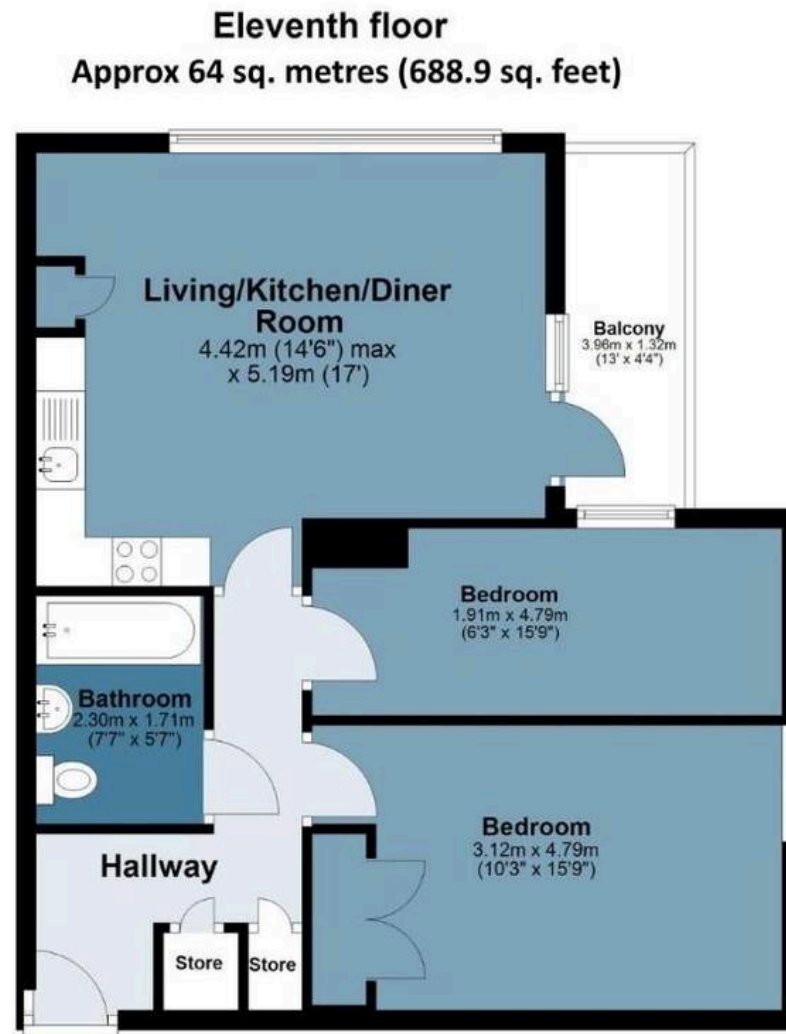

Measurements are approximate and for illustration purposes only. While we do not doubt the accuracy and completeness, we advise you conduct a careful independent assessment of the property to determine monetary value

# FROM EAST LONDON ENERGY TO WEST ESSEX EASE

## We Make Moving Home Easy.

At Butler and Stag, we do more than just connect London to West Essex – we make the move seamless. With offices spanning from vibrant East London to the tranquillity of West Essex, we understand the nuances of each area and the journey people take between them. Our marketing goes beyond standard listings, showcasing every property with precision, creativity, and reach that others simply can't match. Coupled with an unparalleled attention to detail, from first enquiry to final move-in, we ensure every client and customer feels informed, supported, and confident. Simply put, we do the little things that make a big difference, setting us apart in every step of the property experience.



LONDON   STRATFORD   SOUTH WOODFORD   BUCKHURST HILL   LOUGHTON   EPPING   BEYOND

# Like what you see? Let's talk

Book your **FREE** valuation now



020 8102 1236

[london@butlerandstag.com](mailto:london@butlerandstag.com)

508 Roman Road, Bow, London, E3 5LU

[butlerandstag.uk](http://butlerandstag.uk)

IMPORTANT NOTICE - These particulars have been prepared in good faith and they are not intended to constitute part of an offer or contract. We have not performed a structural survey on this property and the services, appliances and specific fittings have not been tested. All photographs, measurements, floor plans and distances referred to are given as a guide and should not be relied upon.

BUTLER & STAG

