



Springer Court, Bow, E3

Guide Price £400,000



## Springer Court, Bow, E3

London

Guide Price - £400,000 to £450,000 A beautifully presented two-bedroom apartment set within a sought-after modern riverside development in the heart of Bow, E3. Offered chain free, this exceptional home spans in excess of 800 sq ft and boasts a private balcony with uninterrupted views across the River Lea.

- Lift Access
- Private Balcony
- Close to Bromley-By-Bow Station
- Views Of River Lea
- Two Double Bedrooms
- Chain Free



Positioned on an second floor, the property offers a superb sense of light and space throughout, enhanced by floor-to-ceiling glazing, dual aspect and a well-considered open-plan layout. The spacious reception area seamlessly integrates with a contemporary fitted kitchen, complete with sleek cabinetry, integrated appliances, and ample dining space—ideal for both everyday living and entertaining. Similar properties in the area highlight the appeal of open-plan living paired with modern finishes and integrated appliances .

The apartment comprises two well-proportioned double bedrooms, with the principal bedroom benefiting from generous built-in storage. A stylish, fully tiled bathroom is finished to a high specification, offering clean lines and modern fittings.

A standout feature of the home is the private balcony overlooking the River Lea, providing a tranquil outdoor retreat—perfect for morning coffee or evening relaxation while enjoying picturesque waterside views. Riverside developments in Bow are particularly sought-after for their blend of scenic outlooks and urban convenience .

Further benefits include excellent storage throughout, lift access, and secure entry systems, all within a well-maintained contemporary development.

Ideally located, the property is within easy reach of Bromley-by-Bow Underground and Devons Road DLR stations, offering swift connections to Canary Wharf, Stratford, and the City. The vibrant surroundings include the green open spaces of Victoria Park and the amenities of the nearby Olympic Park, contributing to the area's strong lifestyle appeal .





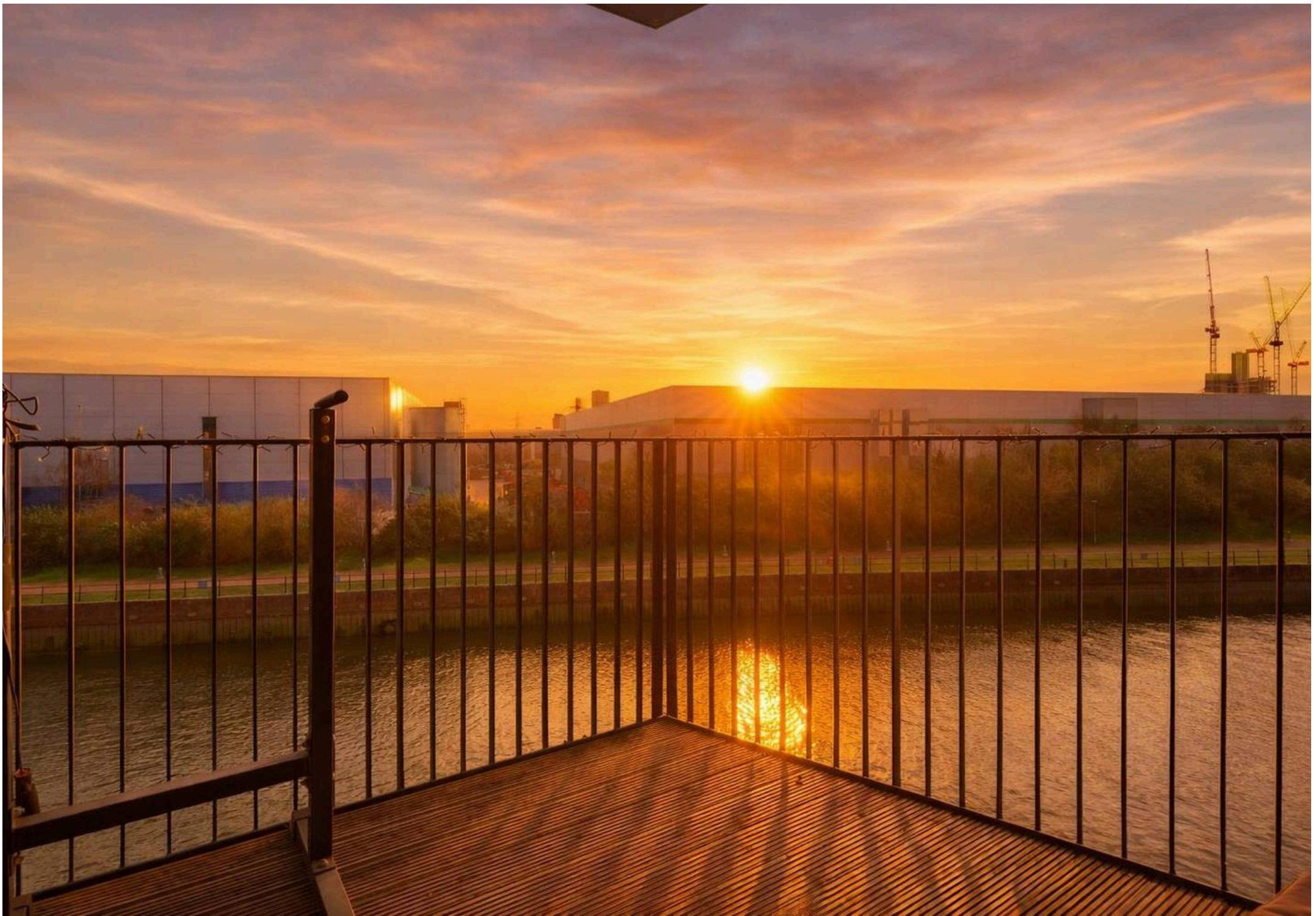

# Springer Court

Approx. Gross Internal Area 75.3 sq. metres 810.19 sq. feet)

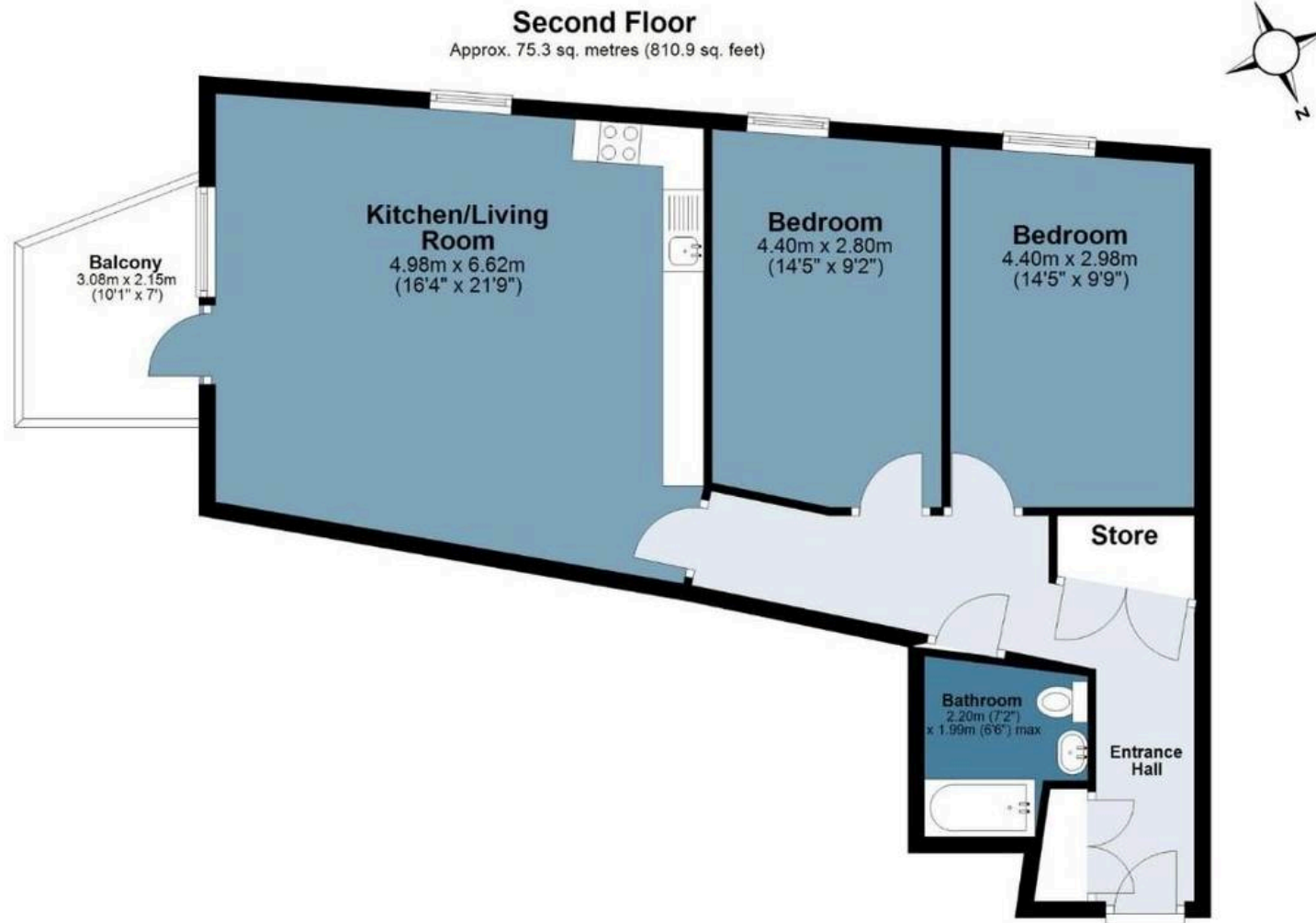

Measurements are approximate and for illustration purposes only. While we do not doubt the accuracy and completeness, we advise you conduct a careful independent assessment of the property to determine monetary value

# FROM EAST LONDON ENERGY TO WEST ESSEX EASE

## We Make Moving Home Easy.

At Butler and Stag, we do more than just connect London to West Essex – we make the move seamless. With offices spanning from vibrant East London to the tranquillity of West Essex, we understand the nuances of each area and the journey people take between them. Our marketing goes beyond standard listings, showcasing every property with precision, creativity, and reach that others simply can't match. Coupled with an unparalleled attention to detail, from first enquiry to final move-in, we ensure every client and customer feels informed, supported, and confident. Simply put, we do the little things that make a big difference, setting us apart in every step of the property experience.



LONDON   STRATFORD   SOUTH WOODFORD   BUCKHURST HILL   LOUGHTON   EPPING   BEYOND

# Like what you see? Let's talk

Book your **FREE** valuation now



020 8102 1236

[london@butlerandstag.com](mailto:london@butlerandstag.com)

508 Roman Road, Bow, London, E3 5LU

[butlerandstag.uk](http://butlerandstag.uk)

IMPORTANT NOTICE - These particulars have been prepared in good faith and they are not intended to constitute part of an offer or contract. We have not performed a structural survey on this property and the services, appliances and specific fittings have not been tested. All photographs, measurements, floor plans and distances referred to are given as a guide and should not be relied upon.

BUTLER & STAG

