



Redmans Road, Whitechapel, E1

Fixed Price £475,000



Redmans Road, Whitechapel, E1

London

A bright and spacious second-floor apartment, ideally located on Redmans Road in the heart of Whitechapel, offered chain free for a smooth and hassle-free purchase.

- Two Bathroom
- Open Plan Concept Living
- Whitechapel Tube Station Close By (Elizabeth Line, District Line, Circle Line)
- Chain Free Purchase
- Two Bedrooms
- 633 Sq/Ft Internal Living Space
- Bright and Spacious Living With Skyline Views
- Second Floor Apartment



This well-presented home features two generously sized double bedrooms, including a principal bedroom with its own en-suite bathroom, alongside a modern bathroom. The property boasts a large, light-filled open plan concept reception room, perfect for entertaining, complemented by a well-appointed fitted kitchen with ample storage and workspace.

Positioned on the second floor, the apartment benefits from an abundance of natural light throughout, enhancing the sense of space and comfort. The layout is thoughtfully designed to maximise both practicality and style, making it ideal for first-time buyers.

Redmans Road offers excellent access to local amenities, vibrant cafés, and transport links, with Whitechapel Station nearby providing convenient connections across London via the Elizabeth Line, Overground, and Underground services.

Offered chain free, this is a fantastic opportunity to secure a well-located and spacious apartment in one of East London's most sought-after areas.

Council Tax band: D

Tenure: Leasehold

EPC Energy Efficiency Rating: B

EPC Environmental Impact Rating: B







Redmans Road

Approx. Gross Internal Area 58.9 sq. metres 633.9 sq. feet)

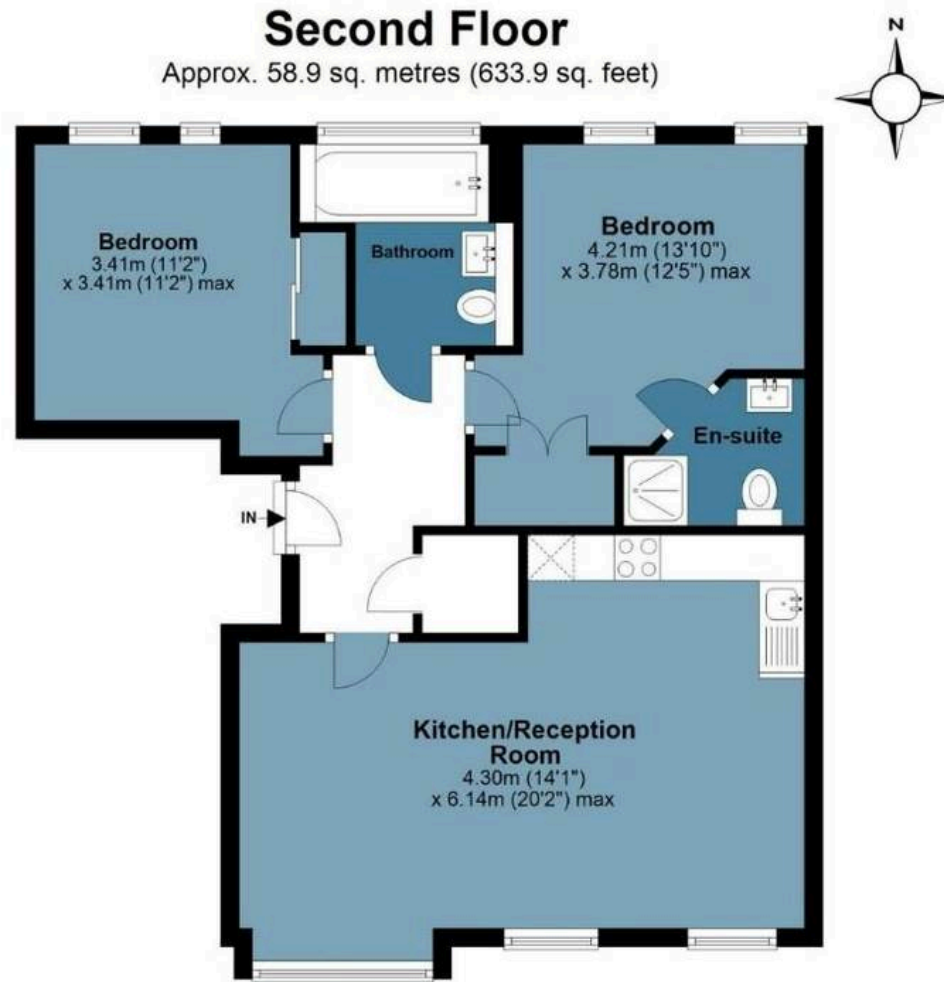

Measurements are approximate and for illustration purposes only. While we do not doubt the accuracy and completeness, we advise you conduct a careful independent assessment of the property to determine monetary value

FROM EAST LONDON ENERGY TO WEST ESSEX EASE

We Make Moving Home Easy.

At Butler and Stag, we do more than just connect London to West Essex – we make the move seamless. With offices spanning from vibrant East London to the tranquillity of West Essex, we understand the nuances of each area and the journey people take between them. Our marketing goes beyond standard listings, showcasing every property with precision, creativity, and reach that others simply can't match. Coupled with an unparalleled attention to detail, from first enquiry to final move-in, we ensure every client and customer feels informed, supported, and confident. Simply put, we do the little things that make a big difference, setting us apart in every step of the property experience.



LONDON STRATFORD SOUTH WOODFORD BUCKHURST HILL LOUGHTON EPPING BEYOND

Like what you see? Let's talk

Book your **FREE** valuation now



020 8102 1236

london@butlerandstag.com

508 Roman Road, Bow, London, E3 5LU

butlerandstag.uk

IMPORTANT NOTICE - These particulars have been prepared in good faith and they are not intended to constitute part of an offer or contract. We have not performed a structural survey on this property and the services, appliances and specific fittings have not been tested. All photographs, measurements, floor plans and distances referred to are given as a guide and should not be relied upon.

BUTLER & STAG

