



18 Jasmine Way, Bedworth

Bedworth

£365,000



**SHELDON  
BOSLEY  
KNIGHT**

LAND AND  
PROPERTY  
PROFESSIONALS

# 18 Jasmine Way

## Bedworth

This impressive four bedroom detached house is situated on a desirable corner plot within a sought-after residential area, offering spacious and versatile accommodation ideal for modern family living. Upon entering the property, you are welcomed by a bright entrance hall that leads to a convenient cloakroom W.C, providing practical storage and facilities for guests. The spacious lounge is designed to offer a comfortable setting for relaxing or entertaining, enhanced by ample natural light and a neutral décor that will suit a variety of tastes. The heart of the home is the generously proportioned dining kitchen, fitted with attractive light oak style units and featuring an integrated hob and oven, making it perfectly equipped for both every-day meals and more formal gatherings (the kitchen provides ample workspace and storage solutions). There is also a utility room with plumbing for a washing machine and space for further appliances. The first floor accommodates two good size bedrooms, each thoughtfully arranged to maximise space and comfort, with the principal bedroom benefiting from its own en suite shower room for added privacy and convenience. A well-appointed family bathroom serves the remaining bedrooms. To the second floor there are two further double bedrooms complemented by an additional shower room that offers further flexibility for busy households (ideal for accommodating guests or larger families). The property benefits from gas central heating and double glazing throughout. For those requiring vehicle parking and extra storage, the property includes a garage and driveway, providing off-road parking for vehicles. The garden to the front elevation is laid to lawn enclosed by





## Ground Floor

Approx. 43.6 sq. metres (468.8 sq. feet)



## First Floor

Approx. 39.6 sq. metres (425.8 sq. feet)

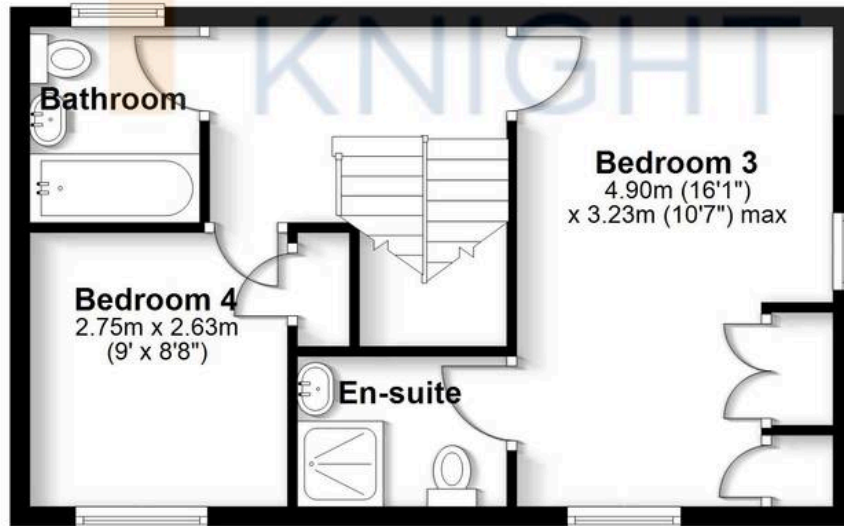

## Second Floor

Approx. 40.0 sq. metres (430.1 sq. feet)

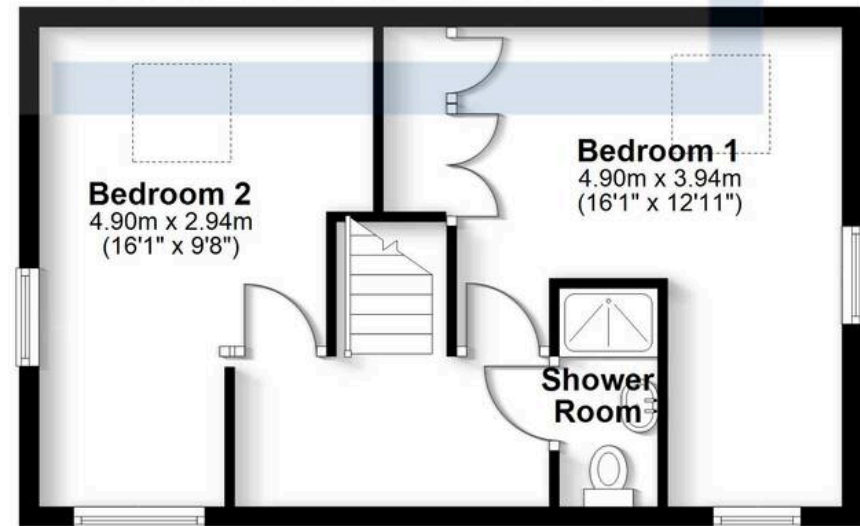

Total area: approx. 123.1 sq. metres (1324.8 sq. feet)

All efforts have been made to ensure the measurements are accurate on this floor plan, however these are for guidance purposes only.  
Plan produced using PlanUp.



## Sheldon Bosley Knight Nuneaton

Sheldon Bosley Knight, 39 Newdegate Street, Nuneaton - CV11 4ER

02476374949 • [nuneaton@sheldonbosleyknight.co.uk](mailto:nuneaton@sheldonbosleyknight.co.uk) • [www.sheldonbosleyknight.co.uk/](http://www.sheldonbosleyknight.co.uk/)