



Mount Pleasant Crescent, London - N4 4HR
£1,850 pcm

**DAVID
ANDREW** | your
most
valuable
asset

A stunning one-bedroom apartment with a spacious balcony, set on the first floor of this period conversion located in the heart of Stroud Green moments from Finsbury Park Station. This inviting one bedroom apartment spread across 481 sq ft (45 sq m) The spacious living room is bathed in natural light thanks to double glazed windows, while elegant wooden flooring adds warmth and character throughout. A separate, fully fitted kitchen provides ample space for culinary pursuits, featuring contemporary units and integrated appliances. The double bedroom is generously sized, creating a peaceful retreat after a busy day. The property benefits from a private balcony, perfect for enjoying fresh air and views.

Ideally situated within walking distance of both Crouch Hill and Finsbury Park stations, you will enjoy excellent transport links to the City and beyond. The surrounding area is known for its vibrant community, with an array of independent cafes, restaurants, and shops nearby, as well as convenient access to local amenities. Offered part furnished and available from the 13th of August.

- One Bedroom Apartment
- Private Balcony
- Comprising 481 sq ft / 45 sq mt
- Separate Kitchen / Living Room
- Fully Fitted Kitchen
- Double Glazed Windows
- Wooden Flooring Throughout
- Walking Distance to Crouch Hill and Finsbury Park Stations
- Offered Part Furnished
- Available 13th of August







Mount Pleasant Crescent

Approximate Gross Internal Area = 486 sq ft / 45.2 sq m

DAVID ANDREW

your most valuable asset

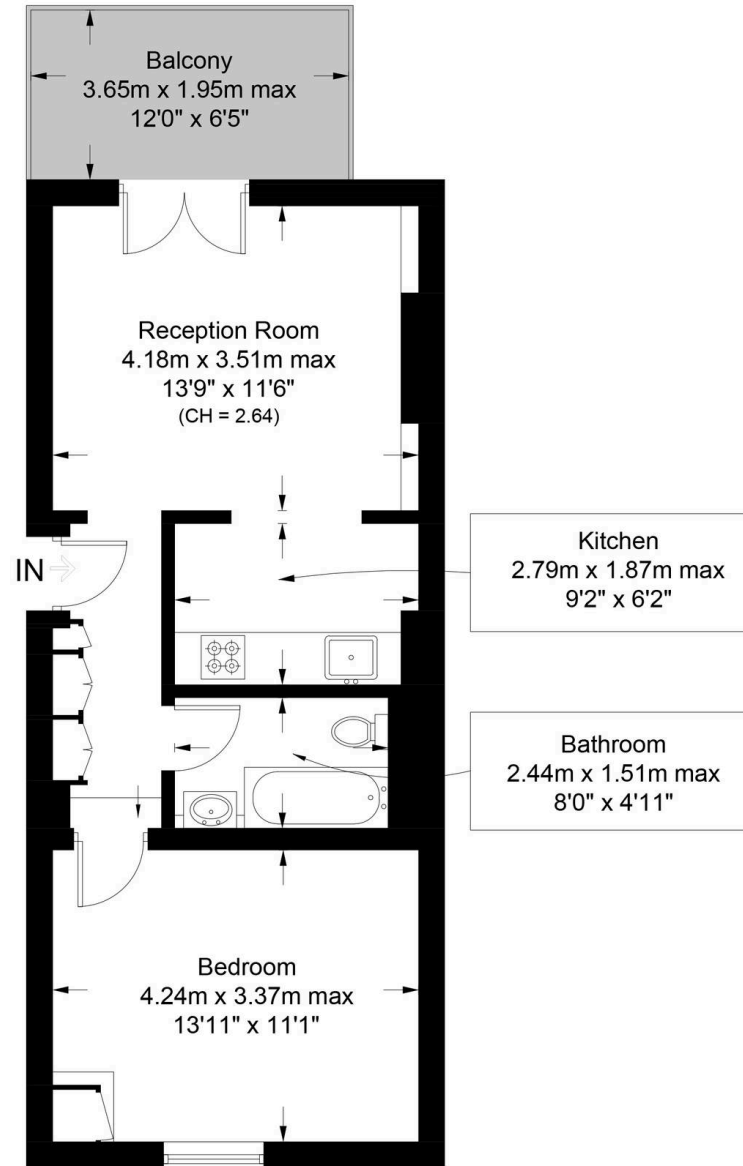

First Floor

This plan is for layout guidance only. Not drawn to scale unless stated. Windows and door openings are approximate. Whilst every care is taken in the preparation of this plan, please check all dimensions, shapes and compass bearings before making any decisions reliant upon them. (ID1306970)



Certified Property Measurer



as been exercised in the of these particulars, out the property must not be as representations of fact. Prospective applicants and rely upon their own d those of professional s. David Andrew Estates bility for any error contained

in these particulars.

Archway Office

671 Holloway Road
London, N19 5SE

T (0)20 7619 3750

Highbury Office

90 Highbury Park
London, N5 2XE

T (0)20 7354 9111

Finsbury Park Office

167 Stroud Green Road
London, N4 3PZ

T (0)20 7281 2000

Property Management Office

235 Blackstock Road
London, N5 2LL

T (0)20 7354 9222

scan to book a viewing

