



Chapel Road, Ollerton

Knutsford

£699,950

**GASCOIGNE
HALMAN**

THE AREA'S LEADING ESTATE AGENCY



Chapel Road

Ollerton, Knutsford

An impressive recently refurbished and significantly extended five bedroom, three bathroom detached bungalow, enjoying breathtaking views over the Cheshire countryside from a peaceful cul-de-sac setting, whilst remaining conveniently positioned for access to Knutsford and the surrounding villages. The property has undergone an extensive programme of improvement in recent years, including a complete re-roof with upgraded insulation, replacement double glazing, updated water tank and comprehensive re-wiring, resulting in a beautifully appointed home perfectly suited to modern day living.

At the heart of the property is a stunning high specification fitted kitchen featuring a striking central island together with a range of integrated appliances. Opening seamlessly into a fabulous living dining room with media wall and stylish inset fire below, this exceptional open-plan space provides the perfect environment for both day-to-day family living and entertaining. Large patio doors flood the room with natural light whilst perfectly framing the spectacular far-reaching countryside views beyond. Located off the kitchen is a particularly useful utility area together with two handy storage cupboards.



Chapel Road

Ollerton, Knutsford

The accommodation is approached via an L-shaped entrance hallway with useful cloaks storage and continues with five well-proportioned bedrooms.

Two bedrooms benefit from well-appointed en suite shower rooms, whilst the superb principal bedroom is further enhanced by fitted wardrobes. The remaining bedrooms are served by a luxuriously appointed family bathroom, with the front-facing bedrooms also enjoying attractive feature bay windows.

Externally, a driveway provides ample off-road parking and pedestrian access to the side of the property leads through to the rear gardens.

Occupying a delightful corner plot, the property enjoys lawned gardens to both the side and rear, together with a shed and summer house. The truly priceless open views across neighbouring Cheshire countryside must be seen to be fully appreciated.

In summary, this is an outstanding opportunity to acquire a beautifully refurbished and thoughtfully extended detached bungalow offering versatile lateral living without compromise within a highly desirable semi-rural setting.



Chapel Road

Ollerton, Knutsford

- Recently Refurbished & Extended Detached Bungalow
- 5 Bedroom & 3 Bathroom
- Fabulous Cheshire Countryside Views
- Peaceful Cul-De-Sac Position
- Stunning Open-Plan Living Dining Kitchen
- High Specification Fitted Kitchen with Island
- Principal Bedroom with En Suite & Fitted Wardrobes
- Generous Corner Plot with Garden & Driveway

Council Tax band: F

Tenure: Freehold

Services (Not Tested): All mains services are connected but have not been tested and you are advised to make your own enquiries and/or inspections.

EPC Energy Efficiency Rating: D

Local Authority: Cheshire East Council

Total Floor Area: 1809 sqft approx

Viewings: Viewing strictly by appointment through the agents.



GROUND FLOOR
1809 sq.ft. (168.1 sq.m.) approx.

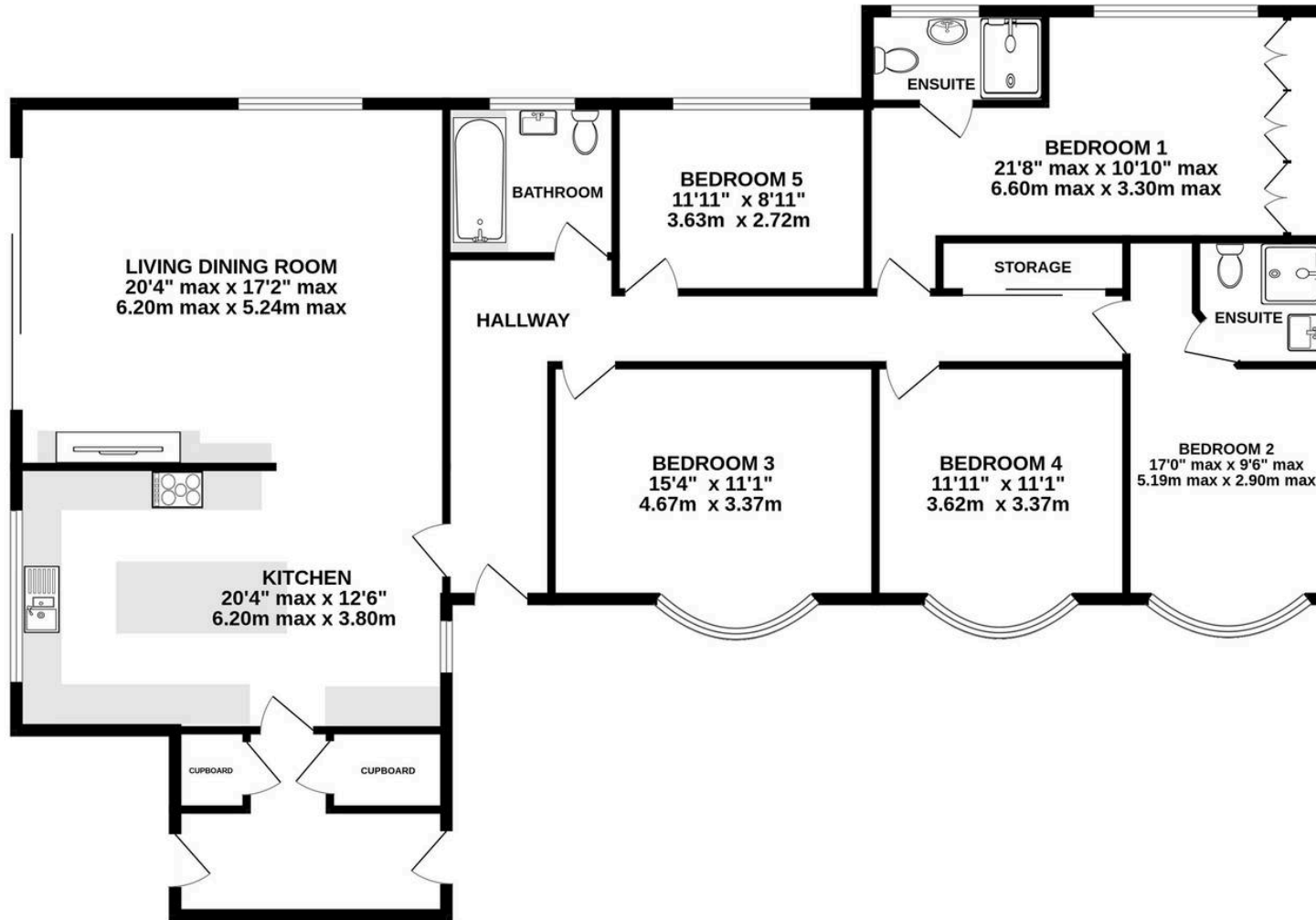

TOTAL FLOOR AREA : 1809 sq.ft. (168.1 sq.m.) approx.
Measurements are approximate. Not to scale. Illustrative purposes only
Made with Metropix ©2026