



Woodcote House Updown Hill, Haywards Heath

Guide Price £190,000 – £200,000

Woodcote House Updown Hill, Haywards Heath

Henry Adams are pleased to present to the market this well proportioned one double bedroom ground floor apartment, situated in the ever popular residential location of Bolnore Vilage

The property is presented to the market with no onward chain, and would make an ideal first time or investment purchase.

Internally, the property benefits from an entrance hall with a range of built in storage. This leads through to a good sized lounge with patio doors to the rear, flooding the room with light. There is also a Juliette balcony, creating the perfect space for summer evenings. The lounge is open plan and leads through to the kitchen, which is well equipped with a range of storage space, modern appliances and further space for white goods.

In addition to this, there is a extremely spacious double bedroom with a range of fitted wardrobe space. The bathroom is accessed either via the bedroom for an en-suite or via the hall for guests, creating a truly unique touch. The bathroom itself is a white suite with both bath and shower facilities.

Externally, the property has an allocated parking space to the rear, with further visitor bays close by. The block also has a secure telephone entry system.









Located in Bolnore Village, there is access to a range of shops, parks and local bus routes. Haywards Heath town centre is also within easy reach, for the mainline train station, supermarkets , cafes and restaurants.
Council Tax band: C

Tenure: Leasehold

EPC Energy Efficiency Rating:

EPC Environmental Impact Rating:

Entrance Hall

Lounge / Diner

Kitchen

Bedroom

Bathroom



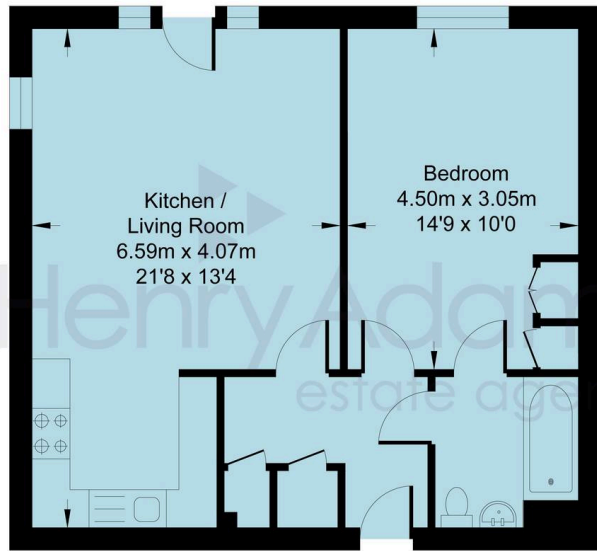

GROUND FLOOR

Updown Hill

Approximate Area = 512 sq ft / 47.58 sq m
For identification only - not to scale





Henry Adams – Haywards Heath

Henry Adams HRR Ltd, 1 Park Parade,, Haywards Heath – RH16 4LX

01444 458380

haywardsheath@henryadams.co.uk

www.henryadams.co.uk/

Agents Note – Our particulars are for guidance only and are intended to give a fair overall summary of the property. They do not form part of any contract or offer, and should not be relied upon as a statement or representation of fact. Measurements, areas and distances are approximate only. Photographs may include lifestyle shots and pictures of local views. No undertaking is given as to the structural condition of the property, or any necessary consents or the operating ability or efficiency of any service, system or appliance. Please ask if you would like further information, especially before you travel to the property.