



65 Japonica Drive, Nottingham – NG6 8PU

Guide Price **£180,000**





65 Japonica Drive

Nottingham

Superb terraced house with trams on the doorstep - ideal for those seeking a simple commute to Nottingham City Centre! Lounge, dining kitchen, 2 double beds and modern bathroom plus tandem parking!

Council Tax band: B

Tenure: Freehold

EPC Energy Efficiency Rating: C

EPC Environmental Impact Rating: C

- Mid-terrace house
- Ideal for a first-time buyer looking to step on the property ladder
- Cinderhill Tram Stop on the doorstep for a simple commute
- Has benefitted from a wealth of improvements by the current owner
- Good-sized lounge
- Dining kitchen with French doors to the garden
- Two first floor double bedrooms
- Bathroom fitted with a three-piece modern suite and a rainfall-style shower
- Southerly-facing low maintenance enclosed rear garden
- Allocated off-street parking to the side



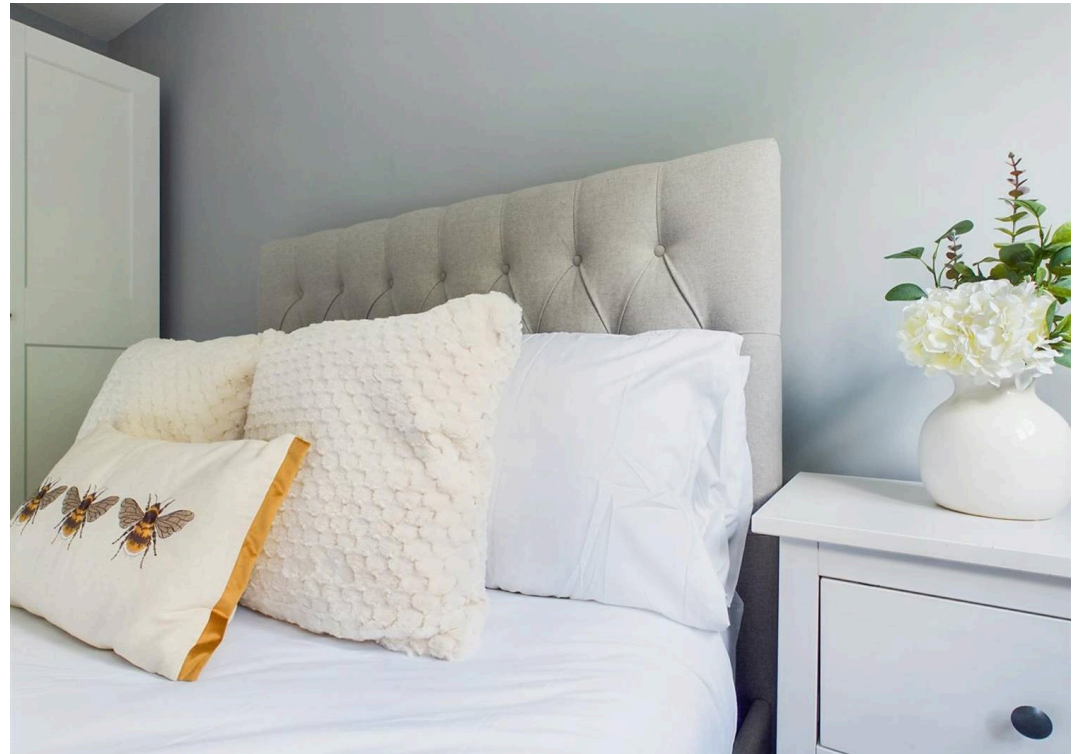



Floor 0

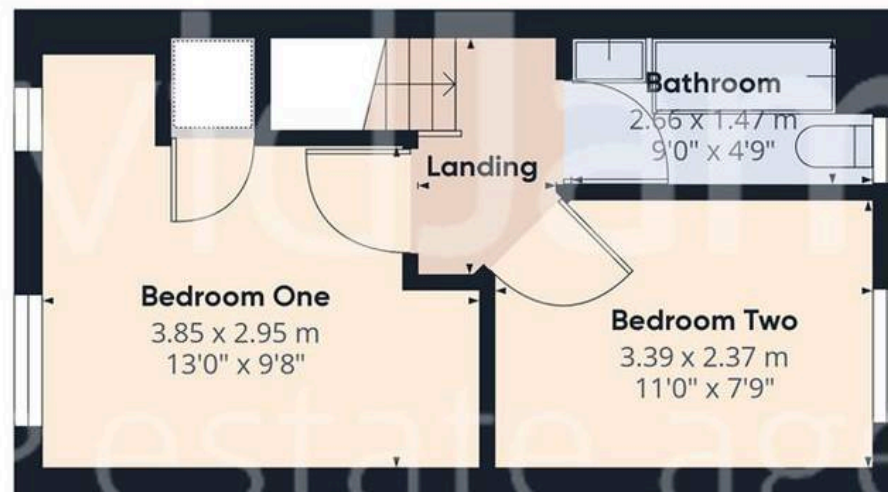

Floor 1

Approximate total area⁽¹⁾

54.3 m²

584.48 ft²

(1) Excluding balconies and terraces

While every attempt has been made to ensure accuracy, all measurements are approximate, not to scale. This floor plan is for illustrative purposes only.

GIRAFFE360

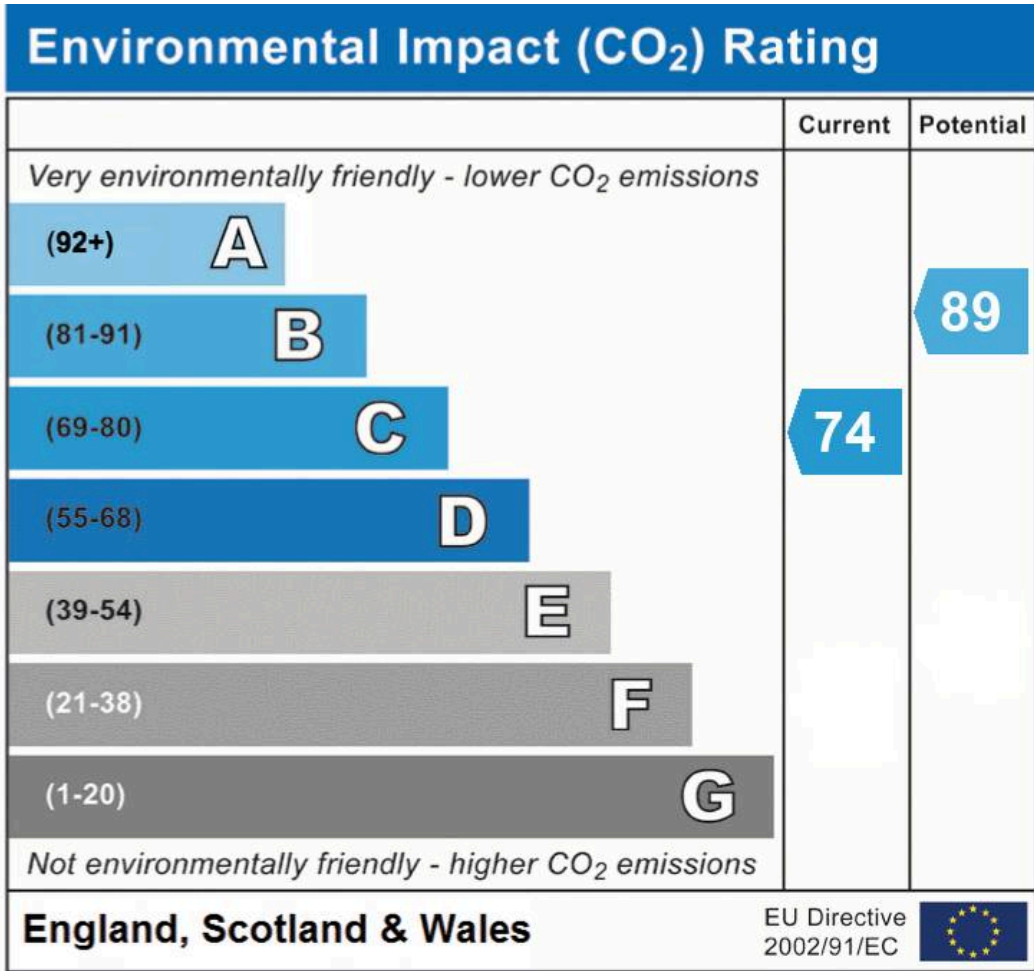
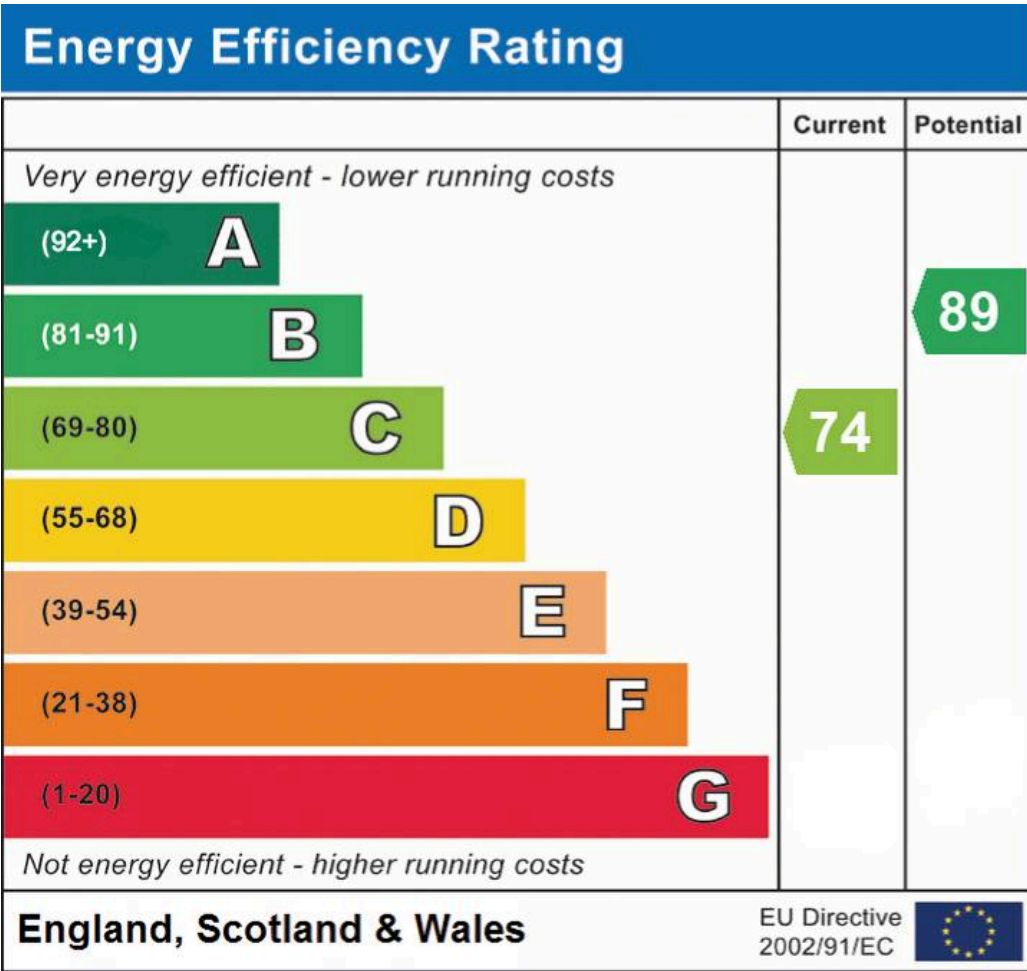

David James Estate Agents

98-100 Front Street, Arnold - NG5 7EJ

0115 955 5550 • arnold@david-james.com • www.david-james.com

These particulars are produced in good faith and are set out as a general guide only. Measurements are approximate and floor plans are for illustrative purposes only. Services have not been tested. We have established professional relationships with third-party suppliers for the provision of services to Clients, details of which can be found on the property listing page on our website.