



10 Kings Avenue, Whitefield
Manchester

In Excess of £230,000

cliveanthony
sales & lettings

10 Kings Avenue

Whitefield, Manchester

Clive Anthony are delighted to offer for sale this three bedroom semi detached home situated on a quiet cul-de-sac being close to local amenities, public transport links, the metrolink and with easy access into Whitefield centre with many bars and restaurants to choose from. NO ONWARD CHAIN. Council Tax band: B

Tenure: Leasehold

- Attractive Rear Garden
- Sought After Location
- Spacious Lounge And Dining Room
- Fitted Kitchen
- Cul-De-Sac Position
- Fitted Bathroom
- Ideal To Improve And Add Value
- Three Bedroomed Semi Detached With No Onward Chain









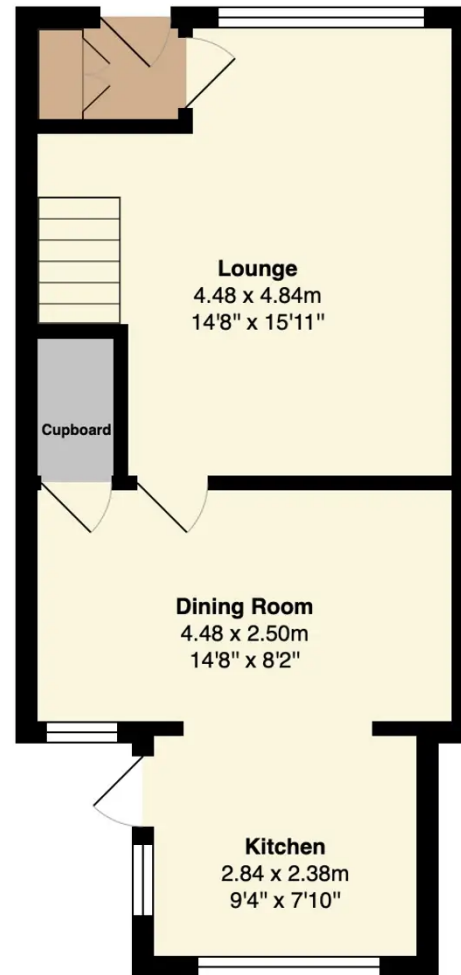

Ground Floor
Area: 40.8 m² ... 439 ft²

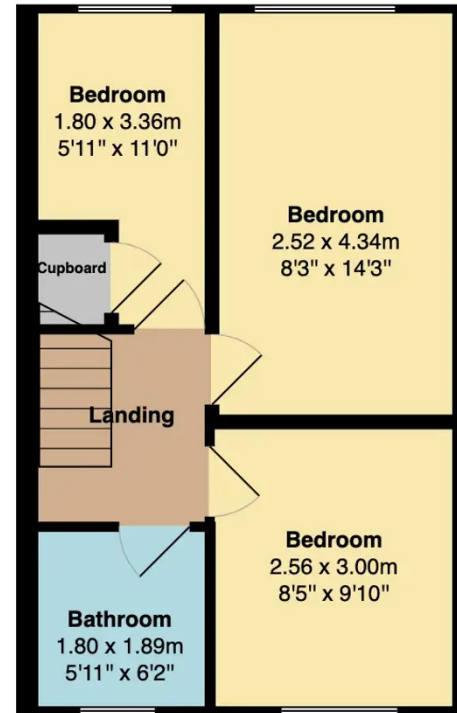

First Floor
Area: 33.6 m² ... 362 ft²

Total Area: 74.4 m² ... 801 ft²



Clive Anthony Sales & Lettings

487 Bury New Road, Prestwich - M25 1AD

0161 773 1111

street@cliveanthony.co.uk

www.cliveanthony.co.uk

cliveanthony
sales & lettings